



CASE WESTERN RESERVE  
UNIVERSITY  
The Alumni Association

# Exploring Galápagos

November 13-22, 2026

Aboard *National Geographic Endeavour II*



SPECIAL AFFINITY GROUP SAVINGS OFFER





## Dear Traveler,

The collection of islands known as the Galápagos is, in the words of Charles Darwin, “a little world within itself.” Here, prehistoric-looking marine iguanas bask on stark volcanic landscapes, barking sea lions loll about on pristine white beaches and magnificent frigatebirds nest in the silvery palo santo trees. Finches flit between tree branches and schools of golden rays swim among the intricate roots of mangrove stands.

We invite you to witness the iconic creatures and habitats of Galápagos for yourself on an incredible voyage aboard *National Geographic Endeavour II*. Equipped with kayaks, stand-up paddleboards, a fleet of Zodiacs and a custom-designed glass-bottom boat, this 52-cabin expedition ship is purpose-built to bring you unforgettable experiences. Paddle along rocky shores beside gliding sea turtles, snorkel with penguins and hike among dancing blue-footed boobies. There will also be plenty of chances to spot marine life—like leaping dolphins and rays—from the comfort of our ship.

Our tour operator, National Geographic-Lindblad Expeditions, has spent decades exploring Galápagos and is well known for the exceptional travel experiences they offer in the archipelago. Their naturalists have a deep knowledge of island species and habitats that allows them to make the most of nature’s opportunities—which means you will enjoy adventure-filled days and amazing wildlife sightings. Many are also Galapagueños, providing an authentic connection to the region’s culture.

**To make your reservation, please return the enclosed reservation form, email [groups@expeditions.com](mailto:groups@expeditions.com) or call 833-985-1261.**

Sincerely,

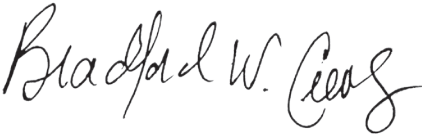

Bradford W. Crews, MNO '21  
Associate Vice President, Alumni Relations  
Case Western Reserve University

### **Special Offer**

**Save 5% when traveling  
with Case Western Reserve  
University/Engaging Journeys.**

---

### **LUMINARY SOCIETY MEMBERS:**

CWRU’s Luminary Society members may receive additional discounts on CWRU Educational Travel programs. For further information on Luminary Society travel discounts only, please contact The Office of Strategic Giving or (216) 368-4460.

# DISCOVER THE MAGIC OF GALÁPAGOS

## A Wilderness Like No Other

Few wildernesses are more iconic than Galápagos—the lava-sculpted realm that once played host to Charles Darwin and this living laboratory. Home to a menagerie of wild and wonderful creatures with no instinctive fear of humans, the archipelago's pristine seas and shores still look much as they did when the legendary naturalist arrived nearly 200 years ago. Penguins welcome visitors while wizened marine iguanas sunbathe on volcanic rocks and giant tortoises roam through misty meadows. Discover these wild wonders and much more on an immersive adventure refined over decades of voyaging to these magical isles.

## Actively Explore Every Day

This Galápagos itinerary features daily activities for every skill level, with each excursion designed to immerse you in the Enchanted Isles. Snorkel with curious sea lions, go on a photo walk to capture up-close images of blue-footed boobies or take a ride in a glass-bottom boat—you can explore your way, multiple ways, every day.

Discover the wonders hidden beneath Galápagos waves through the in-depth undersea program. The voyage features an undersea specialist who documents the marine environment, gathering footage for Daily Recaps in the lounge so that all guests can glimpse the fascinating sea creatures and their oceanic habitats.

*Opposite page (clockwise from top): A blue-footed booby sitting on nest and two chicks; Galápagos flamingo; great blue heron takes flight in front of San Cristóbal Island, Galápagos National Park.*







# GET A NEW PERSPECTIVE ON ICONIC WONDERS

## A Perfectly Appointed Expedition Ship

Outfitted for adventure, *National Geographic Endeavour II* has a range of expedition gear, including kayaks, stand-up paddleboards, a glass-bottom boat, snorkeling equipment and nimble Zodiacs for exploring hidden shores.

On board, discovery continues with superior amenities: read up on Galápagos luminaries in the library before heading to the lounge for the Daily Recap. Or unwind in the fitness center or spa. At every meal, you can savor the flavors of the islands through our pioneering farm-to-table program.



## Travel with a Veteran Team

*National Geographic Endeavour II* has the largest expedition team in our Galápagos fleet, making it ideal for larger groups and younger children. Every staff member—from the naturalists to the expedition leader—is committed to ensuring you have an unforgettable experience. Many of our veteran guides are Galapagueños; in addition to sharing their extensive knowledge of island species and habitats, they offer an authentic connection to local culture.

A National Geographic certified photo instructor also joins the voyage to assist travelers with everything from camera and smartphone settings to composition. Every guest, at every skill level, can stand side by side with top photographers, pick up tips and return home with the photos of a lifetime.

*Opposite page (from top): Guests ride a Zodiac from National Geographic Endeavour II; photography expert Jonathan Kingston with guest, Santa Cruz Island; a Galápagos penguin at rest. This page: Galápagos marine iguanas rest on some rocks.*

# THE GALÁPAGOS ISLANDS



## ISABELA

Raise a glass of Ecuadorian wine as you cross the Equator in sight of Volcán Ecuador, a collapsed caldera that harbors penguins and fur seals. Watch for whales and dolphins in these rich waters, once the haunt of whalers and pirates.



## SANTIAGO

Explore tide pools and search for recently reintroduced land and marine iguanas on this island where a coastal forest and spectacular geological formations are high points.



## FERNANDINA

An oceanic volcano most recently active in 2022, it offers opportunities to walk across lava flows and snorkel with marine iguanas and sea turtles.



## FLOREANA

Follow a trail along a rose-pink lagoon frequented by flamingos. Visit Post Office Bay, founded by 18th-century whalers, and snorkel in neighboring waters with enormous schools of tropical fish.

## HISTORIC MILESTONE IN GALÁPAGOS

The new Hermandad Marine Reserve expands the current Galápagos Marine Reserve by almost 50 percent and extends northwest to the Costa Rican maritime border.

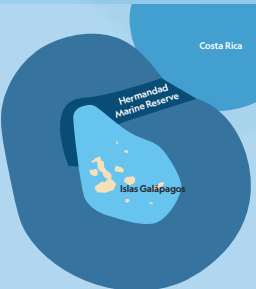



#### GENOVESA

Sail to the remote northern realm of the Galápagos, a seabird paradise bathed in warm tropical waters.



#### BARTOLOMÉ

Climb to the summit of this volcanic wonderland, then snorkel and swim with penguins from a golden beach.



#### NORTH SEYMOUR

Encounter nesting frigatebirds, blue-footed boobies and land and marine iguanas, and enjoy a beautiful coastal walk.



#### SOUTH PLAZA

Sea lions greet us at South Plaza, an uplifted volcanic block carpeted in salt-loving succulents and teeming with wildlife, including a unique species of land Iguana.

#### SAN CRISTÓBAL

Search for red-footed boobies and the endemic mockingbird and lava lizard—found only on this easternmost island. Explore Baquerizo Moreno, where sea lion colonies thrive in the middle of town.



#### SANTA CRUZ

Meet with Galapagueños on the archipelago's most populated island. Visit the Charles Darwin Research Station and explore lush highlands where giant tortoises roam.



#### RÁBIDA

Snorkel along the rocky coastline among schools of tropical fish and curious sea lions before landing on a brilliant red beach to look for both land and sea birds.



#### ESPAÑOLA

The oldest Galápagos island, this is a haven for endemic species and many types of birds, including Española mockingbirds, Nazca boobies and, seasonally, the world's only population of waved albatrosses.



## Itinerary

Explore the legendary Galápagos Islands aboard this comfortable 52-cabin expedition ship, well equipped for active exploration and meaningful encounters with wildlife.



### DAY 1: QUITO OR GUAYAQUIL, ECUADOR

Arrive in Ecuador, either in Quito, Ecuador's capital city in the Andes, or in the coastal city of Guayaquil, for an included transfer to your convenient hotel for an overnight stay. Both cities are well-served by international carriers, and Galápagos flights start and end in Quito with a stop in Guayaquil. Guests in Guayaquil stay at the locally owned Hotel Oro Verde and have the choice of several hotels in Quito.

*Note: For those preferring to fly into Quito and overnight, please note the city sits at a 9,350ft elevation. This is an alternative option to Guayaquil, at no additional cost, and is recommended if guests take advantage of an optional extension.*

### DAY 2: QUITO OR GUAYAQUIL/GALÁPAGOS

This morning, take a required flight to the Galápagos Islands (booked by Lindblad Expeditions at an additional cost) and board *National Geographic Endeavour II*. After lunch, exploration begins of the islands and their diverse wildlife. (B,L,D)

### DAYS 3-8: EXPLORING THE GALÁPAGOS

This expedition includes visits to Santa Cruz and a careful selection of other diverse islands. The itinerary offers an optimal balance of wildlife, landscapes and experiences. All itineraries are subject to Galápagos National Park regulations. Here is a sample of islands you may visit during your expedition. (B,L,D Daily)

#### NORTH SEYMOUR

Follow coastal trails past Galápagos sea lions on this wildlife-rich central island. Continue inland through a silvery forest of endemic palo santo trees, where frigatebirds nest, blue-footed boobies dance and prehistoric-looking land iguanas feeding on cacti.

#### RÁBIDA

Land on a red-sand beach on this volcanically varied island, where you explore inland. You may see flamingos feeding in a brackish lagoon and clownish brown pelicans entertaining from their nests. Jump in the surrounding waters for a snorkel, or explore by kayak or paddleboard.

#### FERNANDINA

One of the most active oceanic volcanoes in the world, Fernandina is the youngest and most pristine island in Galápagos—and home to the strange flightless



cormorant, Galápagos penguins and the largest marine iguanas. On shore, hike across impressive recent lava flows.

## ESPAÑOLA

In this birding paradise, see swallow-tailed gulls, Española mockingbirds and, seasonally, the world's only population of waved albatross. Keep an eye out for vividly colored marine iguanas, and walk amid sea lions on a white-sand beach.



## SANTIAGO

Explore tide pools and look for fur seals sheltered in quiet grottos of black basalt. Swim, snorkel, kayak and paddleboard along spectacular shorelines, and explore an enchanting coastal forest where Charles Darwin once walked.

## SANTA CRUZ

Call at Puerto Ayora, the largest town and headquarters of both the Charles Darwin Research Station and Galápagos National Park. Head to the lush, green highlands to see giant tortoises roaming in the wild.

## SAN CRISTÓBAL

Search for red-footed boobies and the endemic mockingbird and lava lizard—found only on this easternmost island. Explore Baquerizo Moreno, where sea lion colonies thrive in the middle of town.

## DAY 9: GALÁPAGOS/DISEMBARK/QUITO OR GUAYAQUIL

Disembark this morning for a return flight to the mainland. Transfer to Hotel Oro Verde in Guayaquil or to one of several options in Quito, including a convenient airport hotel. The afternoon and evening are at your leisure. You may be able to take advantage of overnight flights home. (B)

## DAY 10: QUITO OR GUAYAQUIL

After breakfast, transfer to the airport and board flights home. (B)

## OPTIONAL EXTENSIONS

### SEE QUITO • 3 DAYS

From your base at the Swissôtel Quito, experience this vibrant city—one of the world's first UNESCO World Heritage sites—with its dazzling colonial churches and bustling traditional markets. Focus your explorations on the Centro Histórico, where a colonial legacy blends with contemporary Andean culture. This extension adds just one night to your voyage, giving you time to get acclimated to Ecuador before your expedition.

### TROPICAL ANDES & COLONIAL QUITO • 6 DAYS

Before your Galápagos adventure, discover the lesser-known wonders of mainland Ecuador on this six-day adventure in the Andes. Explore Quito, a UNESCO World Heritage site, from the comfort of historic Casa Gangotena on Plaza San Francisco. Then immerse yourself in the heart of the Ecuadorian Chocó, one of the world's top five biodiversity hotspots, at Mashpi Lodge.

# National Geographic Endeavour II



This purpose-built expedition vessel sails the Galápagos year-round and embodies the style of travel refined from over more than 55 years of exploration here. Evoking the feel of both a sumptuous hotel and a scientific research vessel, she features an open-air observation deck, exceptional views and an impressive roster of exploration tools—all of which foster up-close and personal exploration.

## Capacity

52 outside cabins and suites accommodating 96 guests.

## Registry

Ecuador.

## Overall Length

236 feet.

## Public Areas

Forward lounge and bar for presentations and gatherings, restaurant, large library with Mac computer kiosks, open-air observation deck, underwater gear area and efficient Zodiac boarding platform, and open Bridge, where guests are welcome to learn about navigation from the captain and officers.



*The casual dining room.*

## Meals

Served in single, unassigned seating in a sociable, informal atmosphere. Menu emphasizes Ecuadorian flair.



*Category 4 cabin.*

## Accommodations

Cabins and suites face outside with large windows and feature twin beds that convert to a queen. With private facilities, climate control, nightstands, desk and storage. Seven sets of cabins with a connecting door and nine solo cabins.

## Expedition Equipment

Zodiacs, glass-bottom boat, kayaks, stand-up paddleboards, snorkel gear including wetsuits for adults and children, video microscope and underwater video camera.

## Staff & Crew

Every staff member is committed to ensuring guests have an unforgettable experience. Many of the veteran guides and naturalists are locally based in your destination and have worked with the company for decades. A full-time doctor, undersea specialist and a National Geographic certified photo instructor are on board, and with a high staff-to-guest ratio, you can hear different perspectives and gain new insights every day.

## Special Features

National Geographic Explorers-in-Training family program, snorkel instruction, Wi-Fi access, laundry service and Global Gallery.

## Wellness

LEXspa and fitness center, exercise classes and wellness specialist.



# Ship Deck Plan & Pricing

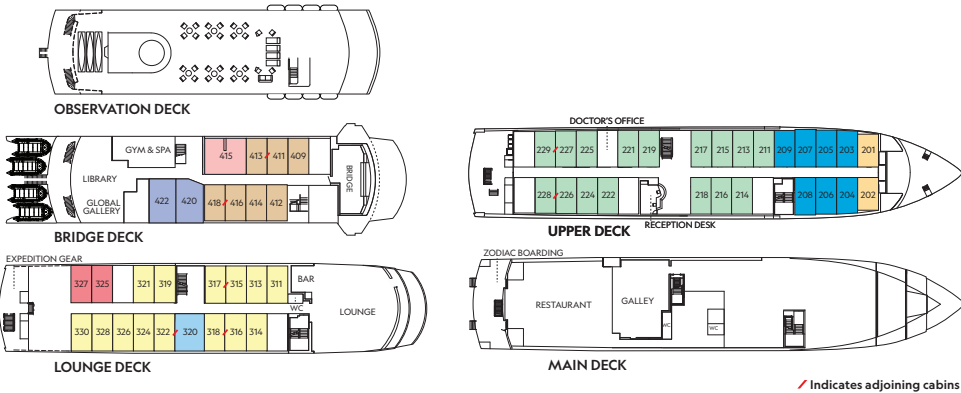

## Voyage Dates

November 13-22, 2026

## Advance Payment Details

15% per person

With compliments, your bar tab and Wi-Fi are included.

Costs are per person double occupancy unless otherwise noted.		5% Savings
<b>Category 1</b>	\$5,557	\$5,279
Upper Deck, Forward #201, 202		
<b>Category 2</b>	\$6,674	\$6,340
Upper Deck #211, 213-219, 221, 222, 224-229		
<b>Category 3</b>	\$7,420	\$7,049
Lounge Deck #311, 313-319, 321, 322, 324, 326, 328, 330		
<b>Category 4</b>	\$8,333	\$7,916
Bridge Deck #409, 411-414, 416, 418		
<b>Suite A*</b>	\$10,011	\$9,510
Lounge Deck, mid-ship #320—with two windows, larger bath, armchair. Connecting door to #322.		
<b>Suite B*</b>	\$10,803	\$10,263
Bridge Deck, mid-ship #420, 422—with two floor-to-ceiling windows, larger bath, convertible sofa for a third person.		
<b>Suite C*</b>	\$11,358	\$10,790
Bridge Deck, mid-ship #415—with two large windows, larger bath, separate sitting area with convertible sofa for a third person and armchairs, largest cabin on ship.		
<b>Category 2 Solo</b>	\$8,676	\$8,242
Upper Deck #203-209		
<b>Category 3 Solo</b>	\$9,645	\$9,163
Lounge Deck #325, 327		

**\*Suite Exclusives:** The Suite Exclusives package gives guests staying in eligible cabins access to an array of amenities designed to enhance your onboard experience, including priority booking for spa treatments, complimentary laundry and other exclusive perks.

**Note:** All cabins and suites feature the option of two singles or a queen bed, plus large window(s), desk, chair and closet.  
**Connecting cabins:** #226/228, 227/229, 315/317, 316/318, 320/322, 411/413, 416/418  
**Triple Occupancy:** #224, 225, 326, 328 with fold-down third berth, Suites B and C with convertible sofa bed. Third person rates are one-half per person double occupancy rate.  
**Shared Accommodations:** Shares can be arranged at the double occupancy rate in Categories 1 and 2.

## INCLUSIVE PRICING

---

- All accommodations aboard ship
- Excursions and hotels, as indicated in the itinerary
- Arrival/departure transfers for hotel arrangements made through National Geographic-Lindblad Expeditions
- All meals as indicated in the itinerary, both aboard and onshore. Meals and hors d'oeuvres are inspired by regional cuisine and locally sourced where possible
- 24-hour access to snacks, premium coffees and teas, non-alcoholic beverages and filtered water
- Beer, wine, cocktails and spirits. Premium wines and liquors are available for purchase
- Selection of exploration tools curated to the Galápagos, including Zodiacs, a glass-bottom boat, stand-up paddleboards, kayaks and snorkeling equipment
- The guidance and company of a leading expedition staff
- Presentations by the expedition staff
- Gratuities in Guayaquil and Quito to local guides, drivers and tour escorts
- Complimentary reusable water bottle
- Services of the ship's physician
- 24-hour access to lounges, observation decks, library and other shared spaces
- Morning stretch classes and 24-hour access to the fitness center
- Assistance by the onboard National Geographic certified photo instructor
- Special access permits, park and site entrance fees and port taxes
- Basic Wi-Fi, with the option to upgrade

## TAKE ADVANTAGE OF SPECIAL OFFERS

---

**SPECIAL AFFINITY GROUP SAVINGS:** Save 5% on the original cabin rates (as indicated) when traveling with Case Western Reserve University/Engaging Journeys. Valid on this departure date of *Exploring Galápagos* for new bookings only, subject to availability, may not be combined with other offers and is not applicable on airfare or extensions.

**BRINGING THE KIDS:** Sharing an expedition with your kids or grandkids is a life-enhancing experience. Take \$500 off the double occupancy price for each person under 18 at the time of travel. Not applicable on extensions or airfare.

## TERMS AND CONDITIONS

---

Prices quoted in this brochure are per person based on double occupancy in USD. Prices quoted are valid at the time of printing, and are subject to change and availability at time of booking. Under normal conditions the total expedition price is guaranteed at the time advanced payment is made. However, our expedition pricing is determined far in advance of initial departure on the basis of then-existing projections of fuel and other costs. In the event of increases in those costs, including but not limited to increases in the price of fuel, currency fluctuations, increases in government taxes or levies or increased security costs, we reserve the right to adjust the price of your expedition or add a surcharge to cover such unexpected increases. We will always provide an explanation of the reason for increase in costs.

**COST INCLUDES:** All amenities listed in inclusive pricing above. Unused services or items included in this program are non-refundable.

**NOT INCLUDED:** Airfare, both international and internal; pre- and post-expedition extensions; additional hotel nights; meals not indicated; travel protection plan; passport, visa and immigration fees; crew gratuities; items of a personal nature such as certain premium wines and liquors, laundry, spa treatments, enhanced and premium Wi-Fi plans and phone services.

**AIRFARE:** Airfare, both international and internal, is an additional cost. International and internal Ecuador tickets must be issued separately. Internal tickets must be booked by Lindblad Expeditions. Lindblad Expeditions will assist in making your international air arrangements for a \$50 per person service fee.

**RESERVATIONS:** To confirm your place, an advance payment of 15% of the cabin fare, per person is payable by Visa, MasterCard, American Express, Discover or check. Receipt of advance payment indicates your acceptance of the terms and conditions.

**FINAL PAYMENT:** Due no later than 120 days prior to departure. Lindblad Expeditions reserves the right to cancel your reservation if payment has not been received by final payment due date.

**TRAVEL PROTECTION PLAN:** Travel and medical insurance are available at an additional cost. Information will be sent to you upon registration.

**ITINERARY MODIFICATIONS:** Itineraries, routing and speakers listed are correct at time of publication, and are subject to change.

**ENTRY AND VISA REQUIREMENTS:** Guests are advised to verify travel documents (passport/transit visa/entry visa) for the country(s) through which they are transiting and/or entering. Reliable and most current information regarding international travel can be found by contacting the consulate/embassy of the country(s) you are visiting or transiting through. We will not be responsible if you are denied entry or transit into a country if you are unable to provide valid documents as per the country's requirement.

**RESPONSIBILITY AND OTHER TERMS & CONDITIONS:** Certain other provisions concerning, among other things, limitations of Lindblad Expeditions' and National Geographic Expeditions' (a division of National Geographic Partners, LLC) liability for loss of property, injury, illness or death during the voyage will be provided to all guests on the ship's ticket sent prior to departure or upon request. By registering for a trip, the guest agrees to all such terms and conditions.

## CANCELLATION FEE POLICY (PER PERSON)

---

**120 or more days prior to expedition start: No penalty:** Advance Payment will be credited toward your next expedition\*\*

**119-90 days prior to expedition start: 50% of trip cost\*\*\***

**89-0 days prior to expedition start: 100% of trip cost\*\*\***

\*\*Advance payments will be credited in the form of a Lindblad Expeditions Travel Certificate, valid for 12 months from the date of cancellation, and which may only be applied towards final payment on any future booking.

\*\*\*Trip cost is total price paid including extensions, charter airfare and other additional services.

We strongly recommend that you purchase a travel protection plan.

**Photo Credits:** Ralph Lee Hopkins, David Vargas, David Spiegel, Sven-Olof Lindblad, Michael S. Nolan, Kyle Furey, SuperStock and Shutterstock.



# Reservation Form



**CASE WESTERN RESERVE  
UNIVERSITY**  
**The Alumni Association**

## Contact Information

**Please send reservation to:**  
Lindblad Expeditions  
96 Morton Street  
New York, NY 10014  
**Ph:** (833) 985-1261  
**Fax:** (646) 390-2050  
**E-mail:** groups@expeditions.com

# Exploring Galápagos

November 13-22, 2026  
ABOARD NATIONAL GEOGRAPHIC ENDEAVOUR II

## Passenger Information

Please reserve \_\_\_\_\_ place(s).

Guest 1: \_\_\_\_\_ Date of Birth: \_\_\_\_\_  
(Name as it appears on passport)

Guest 2: \_\_\_\_\_ Date of Birth: \_\_\_\_\_  
(Name as it appears on passport)

Street Address: \_\_\_\_\_

City: \_\_\_\_\_ State: \_\_\_\_\_ ZIP: \_\_\_\_\_

Home Phone: \_\_\_\_\_ Cell Phone: \_\_\_\_\_

Business Phone: \_\_\_\_\_ Fax: \_\_\_\_\_

Email: \_\_\_\_\_

Accommodations: ☐ Double ☐ Single ☐ Twin share with a friend  
☐ Share with roommate assigned by tour operator.

Please indicate choice of cabin category in order of preference:

1st choice: \_\_\_\_\_ 2nd choice: \_\_\_\_\_

Planned arrival/departure city: ☐ Quito ☐ Guayaquil

Please send me information on the:  
☐ **See Quito** ☐ **Tropical Andes & Colonial Quito** pre-voyage extensions.

**Advance Payment Information:** 15% of the cabin fare per person.

☐ If paying by check, please make payable to: **Lindblad Maritime Enterprises, Ltd.**  
Enclosed is my advance payment of \$ \_\_\_\_\_

☐ If paying by credit card, we will contact you to finalize your booking and collect payment information.

# Exploring Galápagos

## EXPEDITION HIGHLIGHTS

- Travel with an expert team of local naturalists and a National Geographic certified photo instructor.
- Walk among incredible wildlife unfazed by your presence, from giant tortoises and blue-footed boobies to marine iguanas and Sally Lightfoot crabs.
- Experience the waters of the Galápagos by kayak, glass-bottom boat, Zodiac or paddleboard.
- Snorkel amid shimmering fish, sea turtles, penguins and sea lions.
- With the National Geographic Explorers-in-Training family program, kids and teens can learn about and engage with the region through immersive, hands-on activities.

### LINDBLAD EXPEDITIONS:

#### PIONEERING RESPONSIBLE EXPLORATION

From our consistent quest to improve our practices to offsetting 100% of our carbon emissions, supporting conservation science and education initiatives around the planet, and investing in the communities in the places we explore, we are guided by our commitment to explore responsibly.

 Printed on 10% recycled content paper with soy-based inks.  
We recommend that you pass this along for others to enjoy or recycle.



## CASE WESTERN RESERVE UNIVERSITY The Alumni Association

The Alumni Association  
The Frank N. and Jocelyne K. Linsalata Alumni Center  
11310 Juniper Road  
Cleveland, Ohio 44106-7155

PRSRT STD  
U.S. POSTAGE  
PAID  
LINDBLAD  
EXPEDITIONS

GRP-CWRU-GALA26