



Travel to the Belize Barrier Reef, one of the most diverse ecosystems in the world, on this 6-Day/5-Night voyage. Experience the vibrant sea, home to the largest coral reef in the northern hemisphere, just recently taken off UNESCO's endangered list. Snorkel or dive on colorful reefs, and kayak or paddleboard over turquoise lagoons.

If you choose, extend your expedition three nights, and venture to the ancient Maya ruins of Tikal. See temples overgrown with tropical rain forest and explore the stories and archaeological sites of these stone ruins swathed in forest and teeming with wildlife.

DAY 1: GUATEMALA CITY/ PUERTO BARRIOS/ EMBARK

Arrive in Guatemala City and connect with our charter flight to Puerto Barrios. Transfer to Puerto Santo Tomás, where we'll embark the *National Geographic Quest*. (D)

DAY 2: BELIZE BARRIER REEF, BELIZE

Awake anchored in the northern cayes of the Mesoamerican Reef System, second only to Australia's Great Barrier Reef in terms of biodiversity. Enjoy a full day to further explore this dynamic ecosystem. Take to the water by kayak, or stand-up paddleboard, or don a mask and fins and dive into turquoise waters to encounter sea turtles, swirling schools of tropical fish, and harmless nurse sharks. For scuba divers, incredible dive opportunities abound (additional cost). (B,L,D)

DAY 3: BELIZE BARRIER REEF

Today, we explore more of the Belize Barrier Reef in the central cayes, with an opportunity to visit the Smithsonian-operated research station at Carrie Bow Caye. Here, we learn about the comprehensive studies being conducted on the reef ecosystem, including the biodiversity, evolution, and ecology of its organisms and communities, effectively 'taking a pulse' of the reef. The surrounding area offers outstanding snorkeling and diving, with vibrant corals and an incredible

undersea diversity--a tropical paradise both above and below the surface of the Caribbean. (B, L, D)

DAY 4: COCKSCOMB BASIN WILDLIFE SANCTUARY

Spend the morning discovering the Cockscomb Basin Wildlife Sanctuary, the world's first jaguar reserve. Join our naturalists for a hike along one of the reserve's many nature trails to photograph tropical plants, scan the treetops for winged wonders, and spot the tracks of tapirs and jungle cats. Learn about ongoing research into the behaviors of Belize's jaguars,



then visit a Maya handicraft center. Tonight, an internationally acclaimed drumming group, The Garifuna Collective, joins us on board for a festive music performance. (B, L, D)

DAY 5: MONKEY RIVER / BELIZE BARRIER REEF

Early this morning, we board local boats to cruise inland through this coastal river system. Along the river, lined with ceecropia and kapok trees, the throaty roars of mantled howler monkeys echo through the canopy, green and spiny-tailed iguanas languidly laze on overhanging branches and little blue herons, males adorned in their exquisite blue and purple plumage, work the shallows watching and waiting for

small fish, frogs and crustaceans. This afternoon we are back to the reef, this time in the southern cayes, where we go snorkeling, paddleboarding, or kayaking inside its fringing reef dotted with hundreds of coral patches that harbor parrotfish, butterflyfish, octopus, and other marine species. Enjoy the last rays of light as the sun sets on our Belizean adventure. (B, L, D)

DAY 6: PUERTO SANTO TOMAS, GUATEMALA/DISEMBARK

Disembark in Puerto Santo Tomas and catch our charter flight to Guatemala City, where you'll connect with your flight home. (B)



**EXTEND YOUR STAY & VISIT:
RUINS OF THE MAYA WORLD**

9 Days / 8 Nights – FEBRUARY 26 – March 6, 2021

DAY 6: PUERTO SANTO TOMAS, GUATEMALA/FLORES

Disembark in Puerto Santo Tomás and catch our charter flight to Flores, gateway to Tikal—one of the largest cities in the Classic Maya world. Enjoy lunch on the shores of picturesque Lake Petén Itzá before transferring to the Hotel Camino Real Tikal. Later, set out on an optional birding walk with our naturalists, or take a sunset boat cruise on the lake. (B, L, D)

DAY 7: TIKAL

Spend a full day exploring Tikal, where ancient pyramids tower more than 200 feet, and thousands of temples, shrines, and plazas are scattered beneath the rain forest canopy. Discover the site's archaeological treasures, including the Temple of the Great Jaguar and the North and South Acropolis. Encounter ancient Maya art and hieroglyphs and examine carved stone inscriptions that illuminate the history and spiritual significance of Tikal. (B, L, D)

DAY 8: YAXHÁ

Explore Yaxhá, a former Maya ceremonial center situated on a ridge overlooking Yaxhá Lake. The world's third largest known Maya site, Yaxhá spreads across nine plazas and contains multiple pyramids, ball courts, and stelae. Examine its features with your local guides and, if you wish, climb a temple for panoramic views. Later, enjoy lunch at a traditional Guatemalan restaurant, followed by an evening at leisure. (B, L, D)

DAY 9: FLORES / GUATEMALA CITY / U.S.: Transfer to the airport for your flights home. (B)

FREE AIR: Book by July 31, 2020 and receive **FREE ROUND-TRIP** economy group airfare between Miami/Guatemala. Tickets must be issued by Lindblad Expeditions. Upgrade to Business Class is available for \$550. Valid for new bookings only, subject to availability at the time of booking, and may not be combined with other offers, or pre- or post-extensions. Baggage fees may be additional. **Valid for 9-day Belize-Tikal expedition only.** Call for details.

Wild Belize Escape: Wildlife, Reefs & Rivers 6 DAYS / 5 NIGHTS	CAT. 1	CAT. 2	CAT. 3	CAT. 4	CAT. 5 SUITE	CAT. 1 SOLO	CAT. 2 SOLO
	\$ 4,290	\$ 4,590	\$ 4,910	\$ 5,180	\$ 5,990	\$ 6,300	\$ 6,750
Belize to Tikal: Reefs, Rivers & Ruins of the Maya World 9 DAYS / 8 NIGHTS	CAT. 1	CAT. 2	CAT. 3	CAT. 4	CAT. 5 SUITE	CAT. 1 SOLO	CAT. 2 SOLO
	\$ 6,480	\$ 6,780	\$ 7,100	\$ 7,370	\$ 8,180	\$ 8,790	\$ 9,240

Cancellation Policy:

# of Days Prior to Expedition Start	Per Person Cancellation Fee
120 or more days	\$350
119-90 days	Advance Payment Cost
89-60 days	25 % of trip cost
59-45 days	50% of trip cost
44-0 days	No Refund

FOR RESERVATIONS, CONTACT:

Lindblad Expeditions

96 Morton Street
New York, NY 10014

Phone: 888-773-9007 • Fax: 646-390-2050

Email: groups@expeditions.com



National Geographic Quest features 50 cabins accommodating 100 guests; the dining room with large picture windows; category 4 cabin with lower single beds can convert to a Queen and a private step-out balcony. Select cabins connect via an inside doorway.

NATIONAL GEOGRAPHIC QUEST

CAPACITY: 100 Guests in 50 cabins.

REGISTRY: United States. **OVERALL LENGTH:** 238 feet.

Purpose-built to deliver the best possible expedition cruising experience, and designed with over 50 years of expedition heritage, *National Geographic Quest* is able to explore the same remote locations we've sought out for decades, while setting a new standard in comfort and style.

PUBLIC AREAS: Global gallery; fitness center; LEXspa; lounge with full service bar and facilities for films and presentations; observation deck; mudroom with lockers for expedition gear, and a partially covered sundeck with chairs and tables. Our "open bridge" provides guests an opportunity to meet our officers and captain and learn about navigation.

MEALS: Served in single seatings with unassigned tables for an informal atmosphere and easy mingling. Breakfast is a wide selection buffet and dinner is served family-style. Menu emphasizes local fare.

CABINS: All cabins face outside with windows or portholes, private facilities and climate controls. Category 4 cabins have step-out balconies.

EXPEDITION EQUIPMENT: A fleet of 8 Zodiacs and 24 kayaks, Remotely Operated Vehicle (ROV), hydrophone, splash-cam, underwater video camera, video microscope, paddle boards, snorkeling gear for all guests (where applicable).

SPECIAL FEATURES: Guest internet access, elevator, Lindblad certified photo instructor, a video chronicler and undersea specialist.

WELLNESS: The vessel is staffed by a Wellness Specialist and features a gym with an elliptical machine, treadmill, exercycles, handweights and resistance bands. Treatments in the LEXspa are available by appointment.

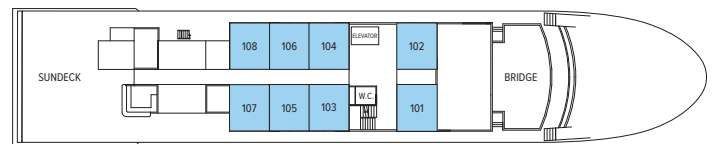

OBSERVATION DECK

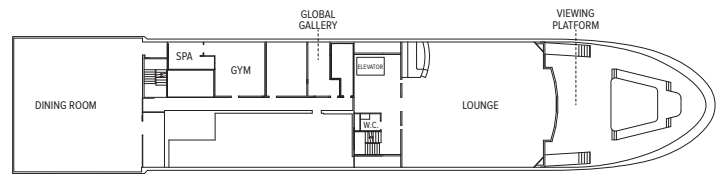

LOUNGE DECK



UPPER DECK

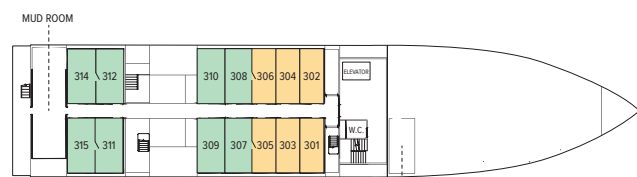

MAIN DECK

CATEGORY 1: Main Deck #301-306 Cabins feature two lower single beds that can convert to a Queen, a writing desk and two portholes.

CATEGORY 2: Main Deck #307-315 Cabins feature two lower single beds that can convert to a Queen, a writing desk and two portholes.

CATEGORY 3: Upper Deck #201-206 Cabins feature two lower single beds that can convert to a Queen, a writing desk and two large view windows.

CATEGORY 4: Upper Deck #207-229 Cabins feature two lower single beds that can convert to a Queen, a writing desk, large view window and small, private balcony.

CATEGORY 5 (SUITE): Observation Deck #101-108 Cabins feature two lower single beds that can convert to a Queen, large view windows, an expanded bathroom, writing desk, ample storage space, and a convertible sofa bed to accommodate a third person.

NOTE: Sole Occupancy cabins are available in Categories 1 and 2 only. Third person rates are available in Category 5 cabins at one half the double occupancy rate.

Connecting Cabins via internal doorway access:
Main Deck: #312-314, #311- 315, #306-308, #305-307
Upper Deck: #224-226, #225-227

BELIZE Costs Include: Five nights' accommodations aboard ship; Charter flights to/from Puerto Barrios (Santo Tomas), Guatemala; all meals and non-alcoholic beverages aboard ship; shore excursions, sightseeing and entrance fees; special access permits; transfers to and from group flights, use of kayaks, snorkeling gear and paddle boards; tips to local guides and drivers; taxes and service charges; services of our expedition staff and the ship's physician.

TIKAL Costs Include: Three hotel nights in Tikal; meals on land as indicated, with non-alcoholic beverages; charter flight Puerto Barrios/Flores (in lieu of taking the Puerto Barrios/Guatemala City flight); gratuities to guides; all inclusions for Belize portion as noted above.

Not Included: International air transportation (unless otherwise indicated); charter flight Flores to Guatemala City (for Tikal portion); scuba diving; extensions; passport, visa, and immigration fees; meals not indicated; alcoholic beverages; travel protection plan; items of a personal nature, such as Wi-Fi, voyage DVD; gratuities to the ship's crew. Unused services or items included in our programs are non-refundable.

Sample Airfares: Internal Charter flight (for Tikal): Flores/Guatemala City: from \$275

Airfares subject to change



THE LAURA & ALVIN SIEGAL
LIFELONG LEARNING
PROGRAM

PLEASE RETURN FORM TO:

Lindblad Expeditions
96 Morton Street
New York, NY 10014

Phone: 888-773-9007

Fax: 646-390-2050

Email: groups@expeditions.com

RESERVATION FORM

WILD BELIZE ESCAPE: WILDLIFE, REEFS & RIVERS

ABOARD *NATIONAL GEOGRAPHIC QUEST* 6 Days | 5 Nights | February 26 - March 3, 2021

Please reserve _____ place(s) on the **FEBRUARY 26 – MARCH 3, 2021, VOYAGE TO BELIZE** expedition.

Passport Name: _____ Date of Birth: _____

Preferred Name for Name Badge: _____ Email _____

Passport Name: _____ Date of Birth: _____

Preferred Name for Name Badge: _____ Email _____

Street Address: _____

City: _____ State: _____ Zip: _____

Primary Phone: _____ Cell Phone: _____

Accommodations: Double Single Twin share w/ friend I need assistance in securing a roommate.

Yes, extend our stay for the **RUINS OF THE MAYA WORLD** (Feb. 26 – Mar. 6, 2021) *Note separate pricing for Belize/Tikal.*

Please contact me about arranging air travel

Yes, I understand my internal air tickets to/from Puerto Barrios, Guatemala are included, and the charter flight Flores to Guatemala City (for Tikal portion) is not included. Internal flights will be booked through Lindblad Expeditions.

Please indicate choice of cabin category in order of preference: 1st choice: _____ 2nd choice: _____

Enclosed is my deposit check of \$750 per person, payable to: **Lindblad Maritime Enterprises, Ltd.**

Charge my deposit of \$_____ (\$750 per person) to my: Visa MasterCard American Express Discover

Account Number: _____ Expires: _____

Cardholder Signature _____ Date: _____