

# Case Center for Imaging Research

## Survey Report – Radionuclide Use Area

Location: **Surgery suite 2  
Lerner B219**

Authorized **R. Muzic**  
User: \_\_\_\_\_

Radionuclides Used: \_\_\_\_\_

Post experiment

Weekly

Semiannual

### Survey map

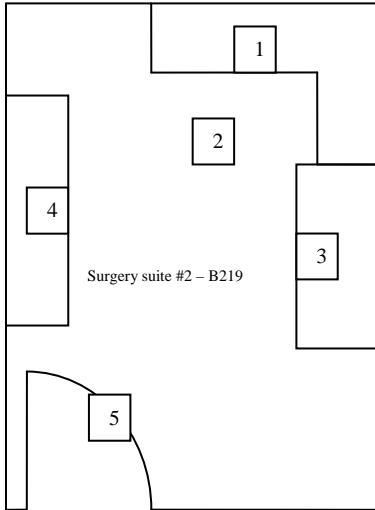

### METER SURVEY:

*Trigger* 200 dpm  
*Level:* /100 cm<sup>2</sup>

Instrument\*

Make: Ludlum  
Model: 14C  
Serial #: 269852

Calibration

Date: 7/11/2014  
Efficiency: 0.82%  
Op. Check: \_\_\_\_\_

Results:

No readings above trigger level

Other: \_\_\_\_\_

### WIPE TEST RESULTS:

*Trigger* 200 dpm  
*Level:* /100 cm<sup>2</sup>

Instrument: Wallac LKB 1282 (SN 446)

Efficiency: 82.4%

**See reverse page for counts**

### SUMMARY OF FINDINGS:

No significant contamination levels / meter readings

Other  
:

\_\_\_\_\_  
Surveyed by (print & sign)

\_\_\_\_\_  
Date

\* Meter calibration sheet on file.

# Case Center for Imaging Research

## Survey Report – Radionuclide Use Area

Date : \_\_\_\_\_

Name : \_\_\_\_\_

Location	Survey			Wipe Test			Notes
	cpm	dpm	< 2x Bkg?	cpm	dpm	< 2x Bkg?	
EFFICIENCY							dpm = (cpm – cpm bkgr)/efficiency
Background							
1 – counter							
2 – floor							
3 – hood							
4 – table							
5 – floor							

\* Values required only when cpm exceed 2x background.