

# Case Center for Imaging Research

## Survey Report – Radionuclide Use Area

Location: **Hot Lab**  
**Lerner B218**

Authorized User: **Muzic**

Radionuclides Used: \_\_\_\_\_

Post experiment

Weekly

Semiannual

### Survey map

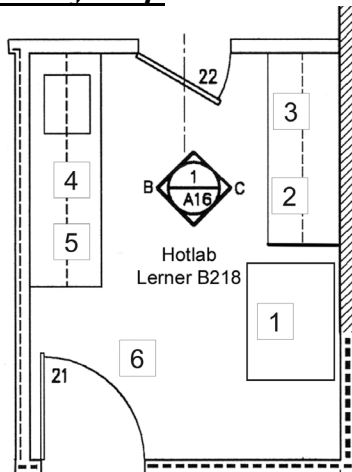

### METER SURVEY:

*Trigger* 200 dpm  
*Level:* /100 cm<sup>2</sup>

Instrument\*  
Make: Ludlum  
Model: 14C  
Serial #: 269852

Calibration  
Date: 07/20/2022  
Efficiency: 0.98%  
Op. Check: \_\_\_\_\_

#### Results:

No readings above trigger level

Other: \_\_\_\_\_

### WIPE TEST RESULTS:

*Trigger* 200 dpm  
*Level:* /100 cm<sup>2</sup>

Instrument: Hidex AMG (SN 2180119)

Efficiency: 45% (01-06-22)

**See reverse page for counts**

### SUMMARY OF FINDINGS:

No significant contamination levels / meter readings

Other:  
: \_\_\_\_\_  
\_\_\_\_\_

\_\_\_\_\_  
Surveyed by (print & sign)

\_\_\_\_\_  
Date

\* Meter calibration sheet on file.

# Case Center for Imaging Research

## Survey Report – Radionuclide Use Area

Date : \_\_\_\_\_

Name : \_\_\_\_\_

Location	Survey			Wipe Test			Notes
	cpm	dpm	< 2x Bkg?	cpm	dpm	< 2x Bkg?	
<b>EFFICIENCY</b>							dpm = (cpm – cpm bkgr)/efficiency
<b>Background</b>							
<b>1 – table</b>							
<b>2 – bench</b>							
<b>3 – bench</b>							
<b>4 – bench</b>							
<b>5 – bench</b>							
<b>6 – floor</b>							

\* Values required only when cpm exceed 2x background.