

Master of Nursing Program

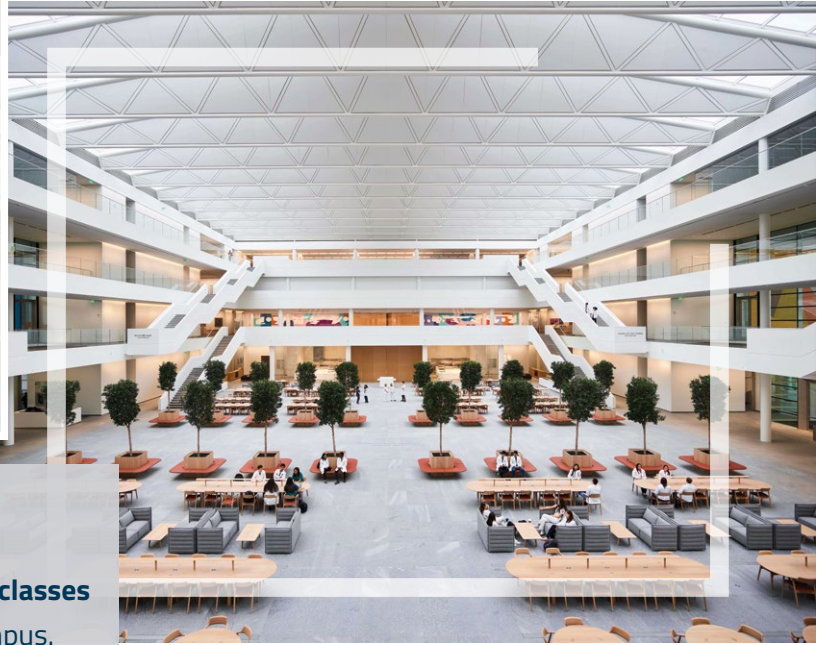

Designed for **students with a bachelor's degree** in a non-nursing discipline, the MN Program offers a rigorous, **accelerated interprofessional education** with **on-campus classes** held at the new, state-of-the-future Health Education Campus.

Admitted Students are Either:

- Baccalaureate Prepared Students
- Senior Year Students in Professional Studies
 - Students begin the MN Program in their senior year of college

MN Graduate Entry Program Overview:

- Degree Awarded: Master of Nursing
- Program Length: 20 months
- Program Start: Fall semester (only)
- Application Deadline: March 1 for fall semester
- RN Licensure: Eligibility conferred upon successful completion of the program

Admission Criteria:

- Bachelor's degree in a non-nursing major from an accredited university, or a university student applying in their junior year of study
- Minimum cumulative GPA of 3.0; 2.75 or higher in the sciences
- Successful completion of program prerequisites

Advanced Practice Nursing:

- MN students are also admitted into the MSN program—no need to reapply
- Students earn 15 credits of MSN coursework during the MN Program
- MN students have the opportunity to pursue an MSN/DNP, DNP, MSN/PhD or PhD degree

High Tech, Hands-On, Interprofessional Education:

- At our new Health Education Campus, clinical skills are enhanced and accelerated through advanced mixed reality and virtual technology. Critical competences are fine-tuned through high fidelity simulations created in our Clinical Skills Simulation Center, Virtual Simulation Lab and Critical Care Transport Center.
- Beginning their first week, students log 1,000 hours of clinical experience at several of the country's top-ranked hospitals including the Cleveland Clinic, University Hospitals, MetroHealth Medical Center, and the VA of Northeast Ohio Healthcare System.
- Interprofessional education prepares our nurses for the collaborative teamwork of health care. IPE brings medical, nursing, dental medicine and physician assistant students together to learn with, from and about each other.

Learn more about the MN Program:

216.368.4700 | admissionsfpb@case.edu
case.edu/nursing/programs/mn-graduate-entry | hec.case.edu



FRANCES PAYNE BOLTON
SCHOOL OF NURSING
CASE WESTERN RESERVE
UNIVERSITY

Pre-Requisite Requirements

Applicants must have at least two prerequisite science courses completed before admission review: Anatomy & Physiology I with lab, Anatomy & Physiology II with a total of at least 6 credits, Microbiology with lab, or Chemistry. Admitted applicants must complete all prerequisite courses with a B- or higher grade before the admitted semester. Prerequisites must be taken within 5 years of enrollment.

BA, BS or BFA with acceptable overall undergraduate GPAs (3.0 cumulative; 2.75 natural science; 2.75 behavioral sciences)

Human Growth and Development Across the Lifespan:
at least 3 credits

Human Anatomy and Human Physiology:
including a lab, a total of at least 6 credits

Microbiology:
1 course, minimum of 3–4 credits with lab

Statistics:
1 course in basic statistics, 3 credits

Chemistry:
1 course, minimum 4 credits may be required for a non-science undergraduate major



Master of Nursing Curriculum

NUMN 401	Introduction to the Discipline and Practice of Nursing	6.5
NUMN 402	Pharmacology for the Advanced Generalist Nurse	3
NUMN 403	Introduction to Health Informatics and Digital Health	1
NUMN 410	Health Assessment for the Advanced Generalist	2.5
NUMN 411	Nursing Care of Populations in Communities	3
NUMN 412A	Collaborative Practice I	2
Total: 18		

NUMN 414	Leadership and Management in Professional Nursing Practice	2.5
NUMN 415	Parents and Neonates in Health and Illness	4.25
NUMN 416	Family-Centered Nursing Care of Children and Adolescents	4.25
NUMN 417	Psychiatric-Mental Health Nursing	4
NURS 425	Inquiry II: Research Process	3
Total: 18		

NUMN 407	Acute Care Nursing of Adults	8.5
NUMN 406	Nursing Care of Older Adults in Health and Illness	2
NURS 405	Inquiry I: Theoretical Foundations	2
NUNP 410	Health Promotion Across the Lifespan	2
NUMN 413	Issues and Ethics in Healthcare	2
NUMN 412B	Collaborative Practice II	1.5
Total: 18		

NUMN 409	Policy for Emerging Nurse Leaders	1.5
NUMN 418	Introduction to Critical Care Nursing	6
NUMN 419	Advanced Generalist Leadership Practicum	2.5
NUMN 420	Clinical Immersion	1
NURS 431	Psychosocial and Spiritual Dimensions of Advanced Nursing Practice	2
NURS 451	Leadership for Quality Healthcare within Organizations and Systems	2
NURS 502	Inquiry III: Evidence-Based Nursing Practice	2
Total: 18		

Accumulated Total Hours: 72

 facebook.com/CWRUNursing

 @fpbnursing

 @fpbnursing

UMC_4658-01_2021

Frances Payne Bolton School of Nursing

Case Western Reserve University
Health Education Campus: Samson Pavilion, 9501 Euclid Avenue, Cleveland, OH 44106
Mailing address: 10900 Euclid Avenue, Cleveland, OH 44106-7343



FRANCES PAYNE BOLTON
SCHOOL OF NURSING
CASE WESTERN RESERVE
UNIVERSITY